



Ruijie RC-RAP2200E Dual Band Ceiling Mount WiFi Access Point Installation Guide

[Home](#) » [RuiJie](#) » Ruijie RC-RAP2200E Dual Band Ceiling Mount WiFi Access Point Installation Guide 

Contents

- [1 Ruijie RC-RAP2200E Dual Band Ceiling Mount WiFi Access Point](#)
- [2 Packing List](#)
- [3 Appearance and Interface](#)
- [4 LED Indicator and Button](#)
- [5 Product Installation](#)
- [6 Network Configuration](#)
- [7 Documents / Resources](#)
- [8 Related Posts](#)



Ruijie RC-RAP2200E Dual Band Ceiling Mount WiFi Access Point



To better use the Ruijie device, read this manual before Installation and usage, and save the manual for future reference.

Packing List

Item	Name	Quantity	Unit
1	RG-RAP2200(E)Host	1	Set
2	Mounting Bracket	1	Piece
3	Phillips Pan Head Screw	2	Piece
4	Expansion Anchor	2	Piece
5	This Quick Installation Guide	1	Copy
6	Warranty Card	1	Copy

Appearance and Interface

Top View

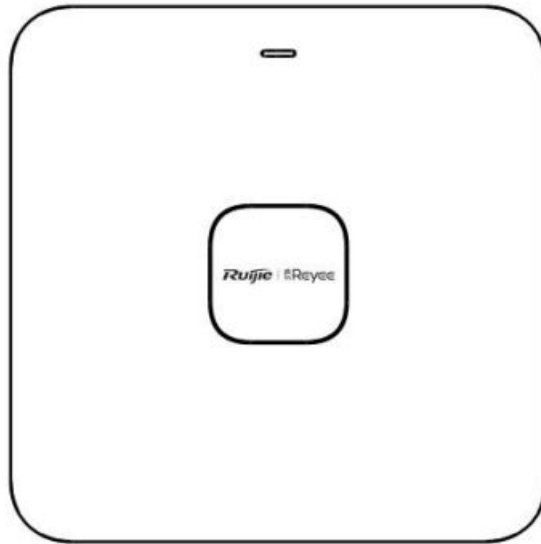

Bottom View

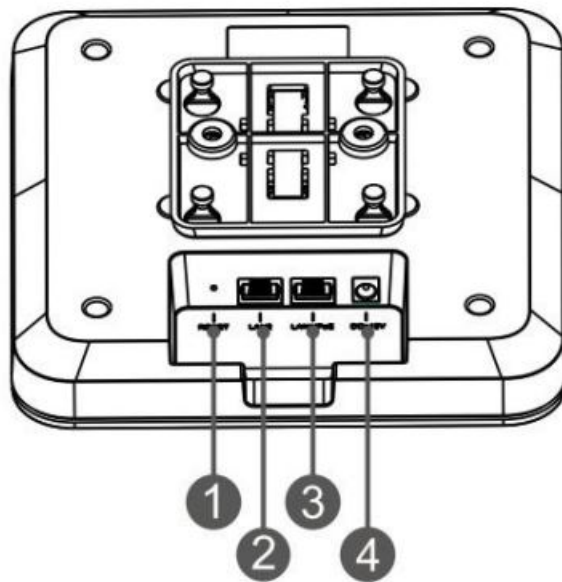

1 Reset button

2 LAN2 port

3 LAN1/PoE port

4 DC-12V power port

1. When powering the AP through PoE, connect one end of the Ethernet cable to LAN1/PoE port and the other end to a PoE-capable device.
2. When powering the AP via local power supply, connect the DC-12V/1.5A power adapter to the power port.

LED Indicator and Button

LED Indicator and Button	Frequency	Description
LED Indicator	Solid green	Normal operation
	Off	The AP not receiving power.
Blinking(0.5Hz)	Normal operation, but the AP is not connected to Ruijie Cloud.	
Fast blinking(10Hz)	Possible cases: 1. Restoring the factory default settings 2. Upgrading the firmware 3.Restoring the image file 4. Initializing the device	
Reset Button	Press for less than 2 seconds	Restart the device
	Press for more than 5 seconds	Restore the factory default settings

Product Installation

Attach the mounting bracket on the ceiling.

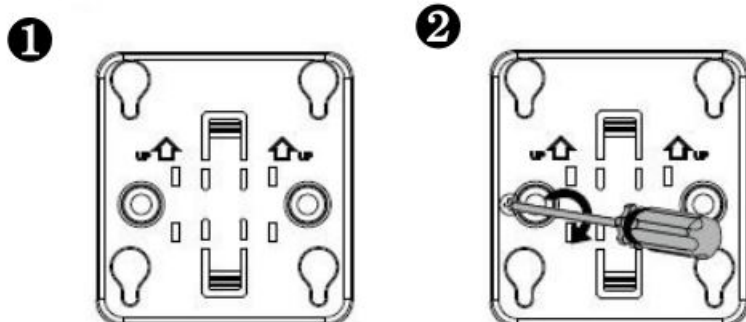

Attach the mounting bracket on the ceiling.

3

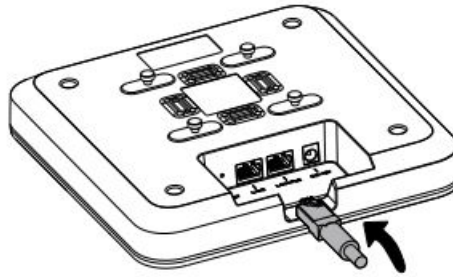

Connect the Ethernet cable to the LAN port

4

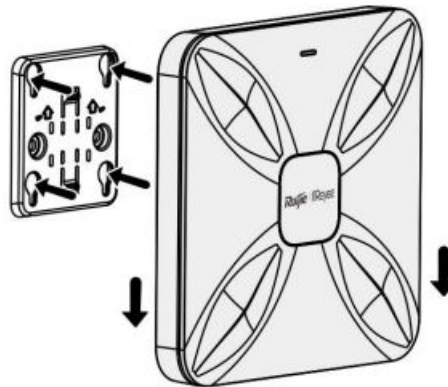

Align the square feet on the rear of the AP over the mounting holes on the bracket. Slide the AP into the holes until it clicks into place.

Network Configuration

Method 1 (Recommended)

Scan the QR-code on the manual or device to download the Ruijie Cloud App, and configure the network according to guide on App.



Method 2

Connect to the SSID (@Ruijie-mxxxx when there are multiple devices and @Ruijie-sxxxx when there is only one device), or connect the cable with LAN port, and visit <http://110.44.77.253> (default password: admin). It is recommended to configure the IP address as 10.44.77.250.

Note: This equipment is restricted to indoor operation in 5.15-5.25GHz for Hong Kong.

Documents / Resources

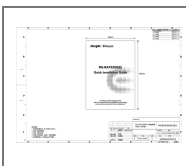

[Ruijie RC-RAP2200E Dual Band Ceiling Mount WiFi Access Point](#) [pdf] Installation Guide 2AX5J-RAP2200E, 2AX5JRAP2200E, rap2200e, RC-RAP2200E Dual Band Ceiling Mount WiFi Access Point, Dual Band Ceiling Mount WiFi Access Point, Ceiling Mount WiFi Access Point, Mount WiFi Access Point, WiFi Access Point, Access Point

